

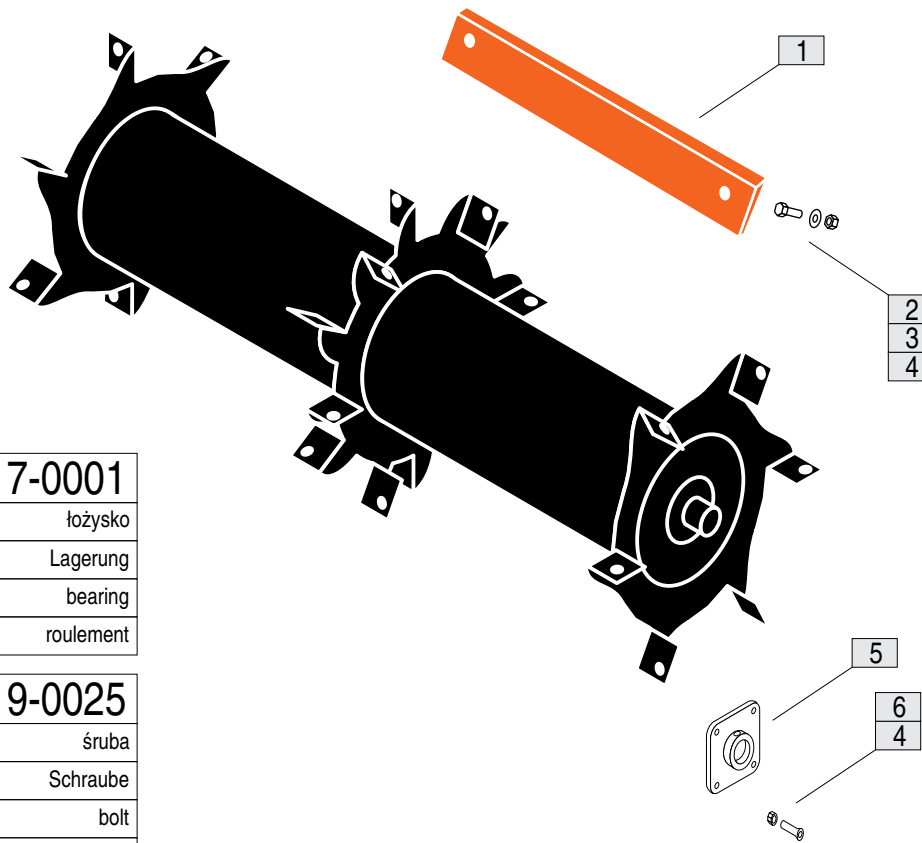
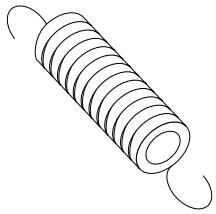
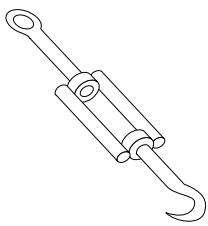
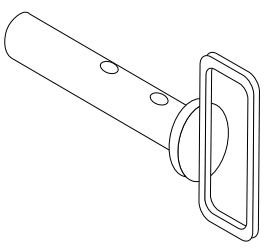

01	05-02-0707	
PL	nóż 492mm	
D	Messer 492mm	
GB	blade knife 492mm	
FR	couteaux 492mm	
02	07-02-0082	
PL	śruba	
D	Schraube	
GB	bolt	
FR	vis	
03	07-10-0011	
PL	podkładka	
D	Pad	
GB	washer	
FR	rondelle	
05	07-17-0001	
PL	łożysko	
D	Lagerung	
GB	bearing	
FR	roulement	
04	07-07-0005	
PL	nakrętka	
D	Mutter	
GB	nut	
FR	ecrou	
06	07-19-0025	
PL	śruba	
D	Schraube	
GB	bolt	
FR	vis	

00	06-16-0012	
PL	sprężyna	
D	Feder	
GB	spring	
FR	ressort	

00	07-02-0149	
PL	ściągacz	
D	Spannschloss	
GB	tumbuckle	
FR	ridoir	

00	20-35-0001	
PL	sworzeń blokady	
D	Schwingenblockade Stift	
GB	swing lockout pin	
FR	boulon-verrou du cadre	
i	WN Tandem 3,0/4,0/5,0/6,0	

01	05-02-0707	
PL	nóż 492mm	
D	Messer 492mm	
GB	blade knife 492mm	
FR	couteaux 492mm	

i ilość noży / Anzahl der Messer /
number of blades / nombre de couteaux

WN 3,0	36
WN 4,0	48
WN 4,0 H	48
WN 5,0 H	60
WN 6,0 H	72

WNT 3,0	90
WNT 4,0	120
WNT 4,0 H	120
WNT 5,0 H	150
WNT 6,0 H	180

08	WN
PL	wały solo bez noży
D	solo Wellen ohne Messern
GB	rollers solo without blades
FR	rouleau solo sans couteaux

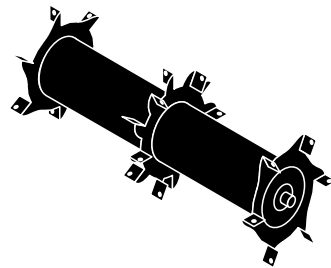

	15-01-1012 380/6 L= 3000mm	15-01-0988 380/6 L= 2000mm	15-01-1059 380/6 L= 1500mm	15-01-0987 380/6 L= 1000mm
WN 3,0	1x	-	-	-
WN 4,0	-	1x	-	2x
WN 4,0 H	-	1x	-	2x
WN 5,0 H	-	1x	2x	-
WN 6,0 H	-	3x	-	-

08	WNTandem
PL	wały solo bez noży
D	solo Wellen ohne Messern
GB	rollers solo without blades
FR	rouleau solo sans couteaux

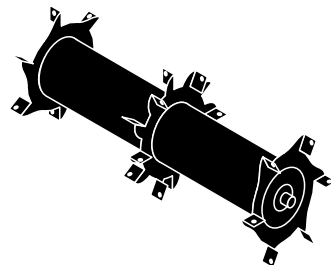

i 1 rząd=8 noży / 1 Reihe= 8 Messern / 1 row= 8 blades / 1 rangée= 8 couteaux

	15-01-0984 460/8 L= 3000mm	15-01-1130 460/8 L= 2000mm	15-01-1034 460/8 L= 1500mm	15-01-1132 460/8 L= 1000mm
WNT 3,0	1x	-	-	-
WNT 4,0	-	1x	-	2x
WNT 4,0 H	-	1x	-	2x
WNT 5,0 H	-	1x	2x	-
WNT 6,0 H	-	3x	-	-

i 2 rząd = 7 noży / 2 Reihe = 7 Messern / 2 row = 7 blades / 2 rangée = 7 couteaux

	15-01-0983 460/7 L= 3000mm	15-01-1131 460/7 L= 2000mm	15-01-1035 460/7 L= 1500mm	15-01-1133 460/7 L= 1000mm
WNT 3,0	1x	-	-	-
WNT 4,0	-	1x	-	2x
WNT 4,0 H	-	1x	-	2x
WNT 5,0 H	-	1x	2x	-
WNT 6,0 H	-	3x	-	-

01	07-02-0215
PL	śruba
D	Schraube
GB	bolt
FR	vis

05	08-02-0460
PL	obejma górna
D	Halter
GB	top clamp
FR	pince supérieure

02	07-12-0030
PL	podkładka
D	Pad
GB	washer
FR	rondelle

06	05-01-0719
PL	guma 45mm
D	Gummi 45mm
GB	rubber 45mm
FR	catouche 45mm

03	07-07-0037
PL	nakrętka
D	Mutter
GB	nut
FR	ecrou

07	05-01-0711
PL	guma 50mm
D	Gummi 50mm
GB	rubber 50mm
FR	catouche 50mm

04	05-02-0616
PL	osłona śruby PVC
D	Kunststoffkappe PVC
GB	bolt cap PVC
FR	capuchon PVC

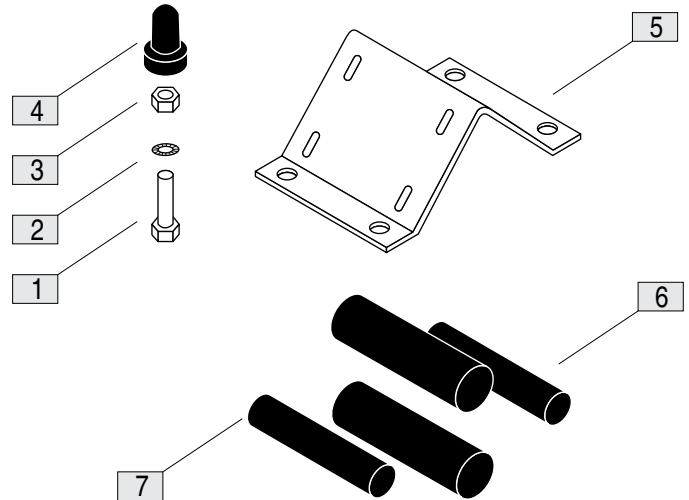

00	20-12-0002
PL	sworzeń stopki
D	Stützfuß Bolze
GB	support leg pin
FR	boulon du support
i	WN 3,0/4,0/5,0/6,0

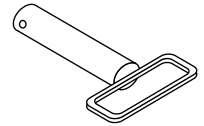

00	20-25-0003
PL	sworzeń górny
D	oberer Stift
GB	top pin
FR	pivot supérieure
i	WN 3,0/4,0/5,0/6,0

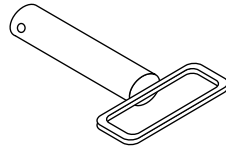

00	20-28-0005
PL	sworzeń dolny
D	unterer Stift
GB	bottom pin
FR	pivot inférieure
i	WN 3,0/4,0/5,0/6,0

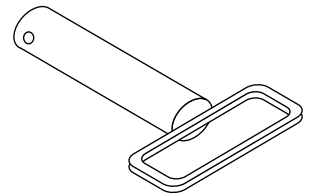

00	20-28-0003
PL	sworzeń górny
D	oberer Stift
GB	top pin
FR	pivot supérieure
i	WN Tandem 4,0/5,0/6,0

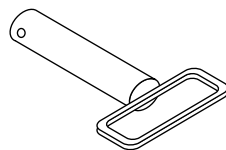

00	20-28-0012
PL	sworzeń dolny
D	unterer Stift
GB	bottom pin
FR	pivot inférieure
i	WN Tandem 4,0/5,0/6,0

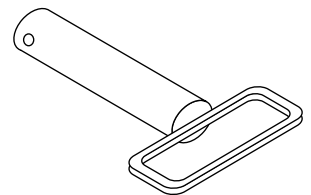

00	08-03-0095
PL	oś rolki
D	Rollachse
GB	roll axle
FR	essieu roulant

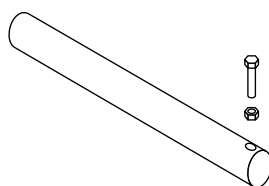

00	08-02-0206
PL	rolka teflonowa
D	Teflonrolle
GB	teflon roll
FR	rouleau de téflon

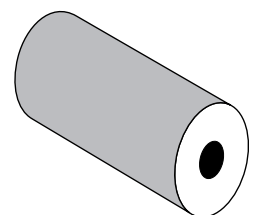

01	05-02-0397	04	07-10-0014
PL	śruba regulacji kąta	PL	podkładka
D	Winkelverstell. Spannschloss	D	Pad
GB	angle adj. turnbuckle	GB	washer
FR	ridoir de réglage d'angle	FR	rondelle
02	20-25-0006	05	08-02-0159
PL	sworzeń 25x100/92	PL	kolek rozprężny
D	Stift 25x100/92	D	Federstift
GB	pin 25x100/92	GB	spring pin
FR	pivot 25x100/92	FR	goupille élastique
03	08-02-0418	06	20-25-0030
PL	tuleja dystans 60/26x14	PL	sworzeń 25x142/130
D	Abstandpad 60/26x14	D	Stift 25x142/130
GB	spacer washer 60/26x14	GB	pin 25x142/130
FR	rondelle entretoise 60/26x14	FR	pivot 25x142/130

